

STRIKER SOCCER GOALS - 3" ROUND

MODELS: SG3RD612SPT, SG3RD618SPT, SG3RD721SPT, AND SG3RD824SPT

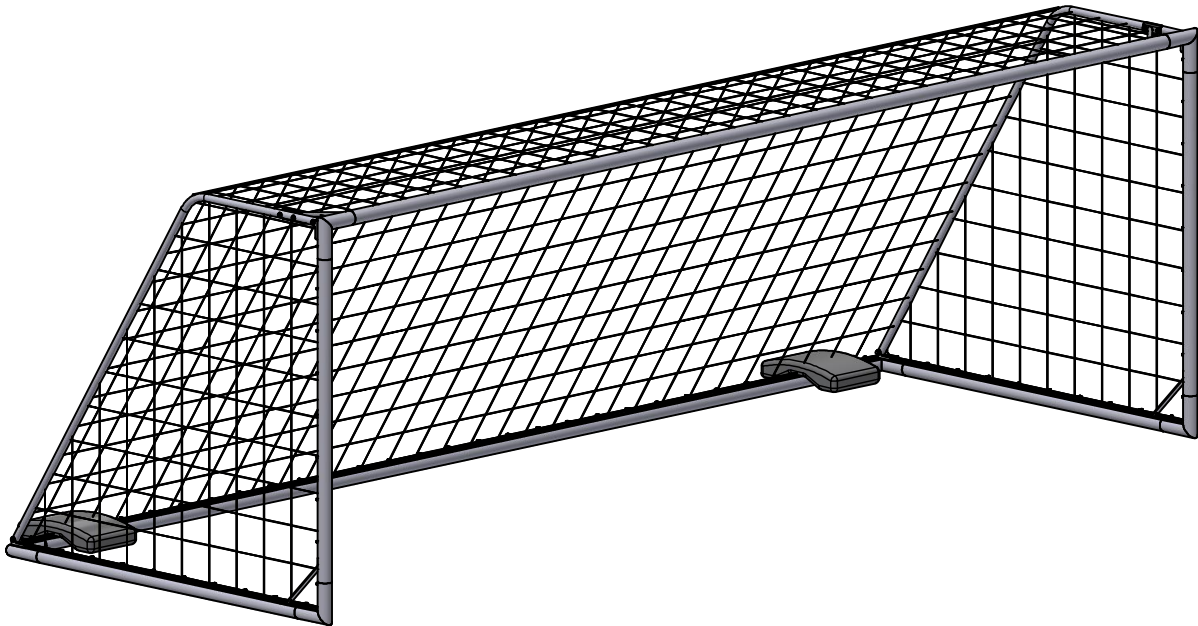

⚠ WARNING

Portable or Moveable Soccer Goals can fall over causing serious injury or death. Anchors must be properly installed and used on all portable or moveable soccer goals at ALL times.

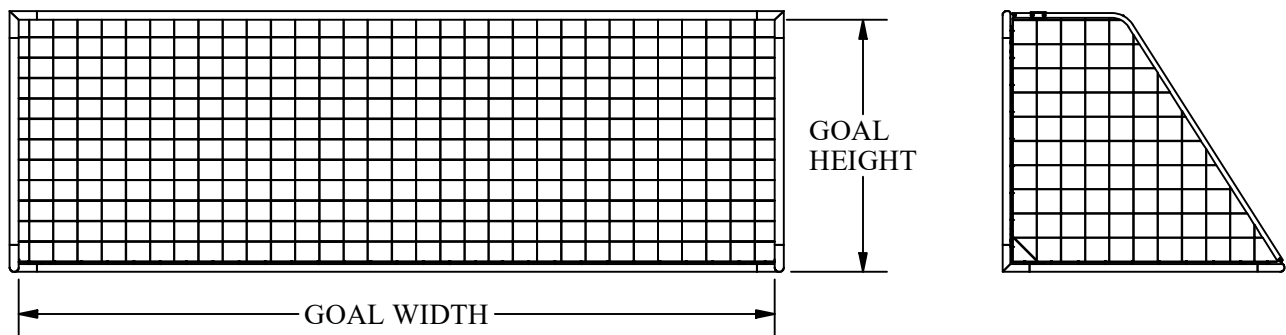

Please read & understand all instructions before attempting installation or operation of these units.

Installation and Assembly Instructions, Operators Manual, and Maintenance Manual



Gared Performance
Sports Systems
info@garedperfsports.com
800-325-2682

PORTABLE STRIKER SOCCER GOALS - 3"
ROUND FRAME: SG3RDSPT

DATE	SHT. NO.	PART NO.	REV
8/4/2025	1 OF 21	651752129	

Table of Contents

<u>Section</u>	<u>Page No.</u>
Introduction/Liability Disclaimer	2
Safety Instructions	3
Parts Checklist	4
Parts Illustration	5-6
Assembly Tools	6
Goal Assembly	7-19
Storage Guidelines	20
Maintenance	21

Introduction/Liability Discalimers

Thank you for your purchase of the SG3RDSPT Soccer Goal. To ensure that our equipment will provide years of use to you, we are including this installation, operation, and maintenance guide. This guide will provide information on the proper assembly and installation methods, operating procedures, and preventative maintenance of your soccer goal.

Please note that a Bill of Materials is being included with this guide. Please check that all of the parts called out on the Bill of Materials are present prior to beginning assembly. Please do not substitute for factory parts. Please contact the GPSS customer service department and allow them to determine if substitute parts are acceptable.

It is recommended that an individual who has been properly trained perform assembly and set up of the Soccer Goal. No one under the age of 18 should attempt assembly or set up of the unit, unless properly supervised.

To prevent normal wear and tear from shortening the life of the unit, preventative maintenance inspections and repairs should be performed at least once per year. If the units are subject to high or unusual usage, inspections should be scheduled to occur more frequently. If items are found to be nonconforming, replacements can be ordered from Gared Performance Sports Systems or one of our authorized dealers. When contacting GPSS, please have information regarding the dealer/installer who sold the unit, the name of the project, and any applicable warranty information.

Before proceeding with assembly, read all instructions and assembly procedures. Make sure all parts have been received and are not damaged.

SAFETY INSTRUCTIONS

Read and understand the following cautions and warnings to prevent possible personal injury and potential damage to the equipment during assembly, setup, and operation.

**WARNING**

- This goal should be securely anchored at all times
- This goal is not to be stored or used on a slope or hill area
- Check that all fastenings are fully tightened before using this product
- Check fastenings periodically after using goal
- Goal shall be secured against overturning at all times
- Do not climb on net or framework
- This goal is designed to be used for soccer only

126201545

**WARNING**

NEVER CLIMB ON GOAL
GOAL CAN FALL OVER CAUSING
SERIOUS INJURY OR DEATH

126201546

**WARNING**

ALWAYS ANCHOR GOAL
UNSECURED GOAL CAN FALL OVER
CAUSING INJURY OR DEATH

126201547

1. Check for structural integrity and proper connecting hardware before every use. Replace damaged or missing parts or fasteners immediately.
2. Ensure safety/warning labels are clearly visible (placed under the crossbar and on the sides of the uprights at eye level).
3. Securely anchor movable soccer goals at ALL times, except when being moved.
4. Always instruct players, managers, coaches, trainers, teachers, maintenance and all other personnel who might come into contact with the goal on the safe handling of and potential dangers associated with movable soccer goals.
5. Always exercise extreme caution when moving goals and allow adequate manpower to move goals of varied sizes and weights. Movable soccer goals should only be moved by authorized and trained personnel.
6. NEVER allow anyone to climb on the net or goal framework.
7. Movable soccer goals should only be used on LEVEL fields, NEVER on a slope or hill area.
8. Remove nets when goals are not in use.
9. Most of the tip over injuries occurred when goals were unattended. Anchor or chain one goal to another, or to nearby fence posts, dugouts, or any other similar sturdy fixture when not in use. If this is not practical, store movable soccer goals in a place where children cannot have access to them.
10. Fully disassemble goals for seasonal storage.

**"Meets Safety and
Performance Specification"**
ASTM F2950-14
126201548

Parts Checklist

Verify all parts listed on the packing list are present prior to installation.

Part quantities are for one goal.

			6'-6" X 12'	6'-6" X 18'-6"	7' X 21'	8' X 24'
Item	Description	QTY	SG3RD612SPT	SG3RD618SPT	SG3RD721SPT	SG3RD824SPT
1	CROSSBAR CORNER WELDMENT	4	656202360W	(Common to all goals this series)		
2	CROSSBAR	2	656202391W	656202387W	656202382W	656202377W
3	SIDE RAIL CORNER WELDMENT	2	656202126	(Common to all goals this series)		
4	SIDE RAIL	2	656202432	656202432	656202433	656202434
5	BOTTOM SIDE RAIL	2	656202435	656202435	656202436	656202437
6	STRIKER BACKSTAY	2	656202351	656202351	656202352	656202353
7	STRIKER HARDWARE KIT	1	156201503	(Common to all goals this series)		
7.1	BACKSTAY ATTACHMENT BRACKET	4	656202416	(Common to all goals this series)		
7.2	CLAMP PLATE	4	656202371	(Common to all goals this series)		
7.3	STRIKER FRAME BRACE	2	656202349	(Common to all goals this series)		
7.4	STRIKER BRACE WELDMENT	2	656202424	(Common to all goals this series)		
7.5	HEX BOLT, 5/16-18 UNC X 0.875 SS	8	502-5-18-14SS	(Common to all goals this series)		
7.6	HEX BOLT, 3/8-16 UNC X 1.5 SS	24	502-6-16-24SS	(Common to all goals this series)		
7.7	HEX BOLT, 3/8-16 UNC X 2.5 SS	4	502-6-16-40SS	(Common to all goals this series)		
7.8	HEX BOLT, 3/8-16 UNC X 2.75 SS	4	502-6-16-44SS	(Common to all goals this series)		
7.9	HEX NUT, NYLON LOCK 3/8-16 SS	8	545-6-16SS	(Common to all goals this series)		
7.10	FLAT WASHER 3/8 SS	40	561-6SS	(Common to all goals this series)		
7.11	SPLIT LOCK WASHER 5/16 SS	8	562-5SS	(Common to all goals this series)		
7.12	SPLIT LOCK WASHER 3/8 SS	24	562-6SS	(Common to all goals this series)		
7.13	PLASTIC BOLT CAP	8	101651139	(Common to all goals this series)		
7.14	NET CLIP (50 PER BAG)	100	651652567	(Common to all goals this series)		
7.15	GPSS SOCCER DECAL	2	121651521	(Common to all goals this series)		
7.16	GENERAL SOCCER WARNING LABEL	1	126201545	(Common to all goals this series)		
7.17	NEVER CLIMB WARNING LABEL	2	126201546	(Common to all goals this series)		
7.18	ALWAYS ANCHOR WARNING LABEL	2	126201547	(Common to all goals this series)		
7.19	ASTM F2950-14 LABEL	2	126201548	(Common to all goals this series)		
7.20	SOCCER WT BAG W/ HANDLE	2	SGSB	(Common to all goals this series)		
8	SOCCER NET	1	SN612-3W	SN618-3W	SN721-3W	SN824-4W

**Installation and Assembly Instructions,
Operators Manual, and Maintenance Manual**

DATE
8/4/2025

SHT. NO.
4 OF 21

PART NO.
651752129

REV

Parts Illustration

NOTE:

Balloon numbers throughout this manual will match the Item numbers in the Parts Checklist.

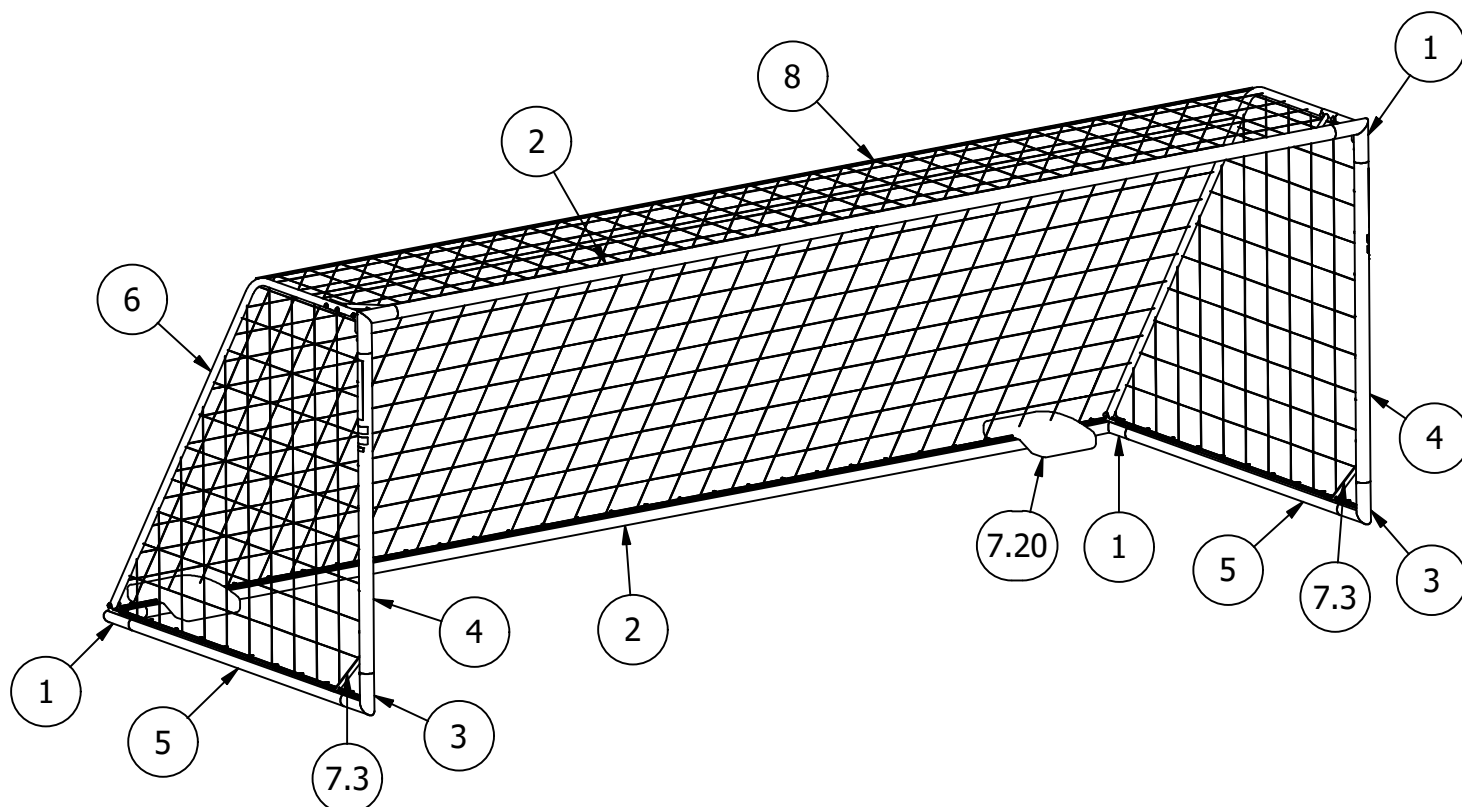

ITEM 7.1: BACKSTAY
ATTACHMENT BRACKET
(PN: 656202416)

ITEM 7.2:
CLAMP PLATE
(PN: 656202371)

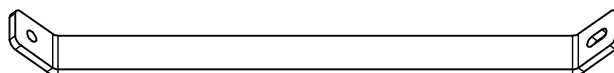

ITEM 7.3: STRIKER FRAME BRACE,
3" ROUND SOCCER
(PN: 656202349)

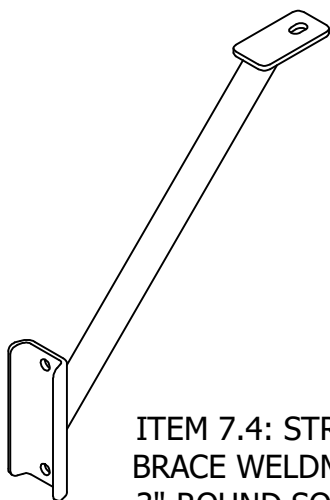

ITEM 7.4: STRIKER
BRACE WELDMENT,
3" ROUND SOCCER
(PN: 656202424)

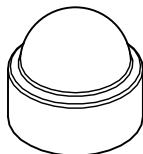

ITEM 7.13:
PLASTIC BOLT CAP
(PN: 101651139)

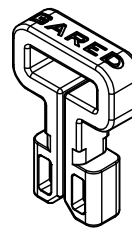

ITEM 7.14: NET CLIP
(PN: 651652567)



ITEM 7.15: GPSS SOCCER DECAL
(PN: 121651521)

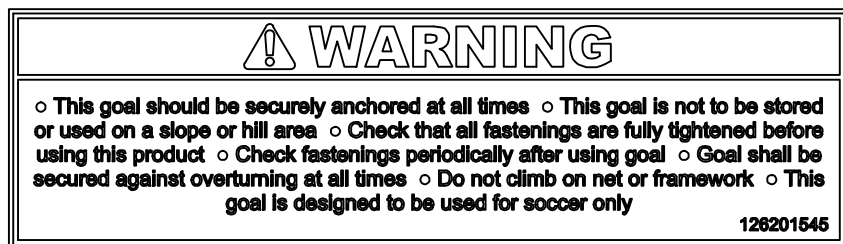

ITEM 7.16: GENERAL SOCCER WARNING LABEL
(PN: 126201545)



ITEM 7.17: NEVER
CLIMB WARNING LABEL
(PN: 126201546)



ITEM 7.19: ASTM
F2950-14 LABEL
(PN: 126201548)



ITEM 7.18: ALWAYS
ANCHOR WARNING LABEL
(PN: 126201547)

Assembly Tools

- Two Socket Wrenches
- Two Sockets: 9/16"
- Wrenches: 1/2" and 9/16"
- Tape Measure
- Ladder

Goal Assembly

Step 1:

Attach a Backstay Attachment Bracket (ITEM 7.1) to one side of each of the Crossbar Corner Weldments (ITEM 1) as shown in the following illustration. Use 5/16" x 7/8" Bolts (ITEM 7.5) and 5/16" Lock Washers (ITEM 7.11) to attach the bracket. The Clamp Plate (ITEM 7.2) fits into the channel in the extrusion as shown. Slide the bracket fully up and hand tighten the bolts. Go to step 2.

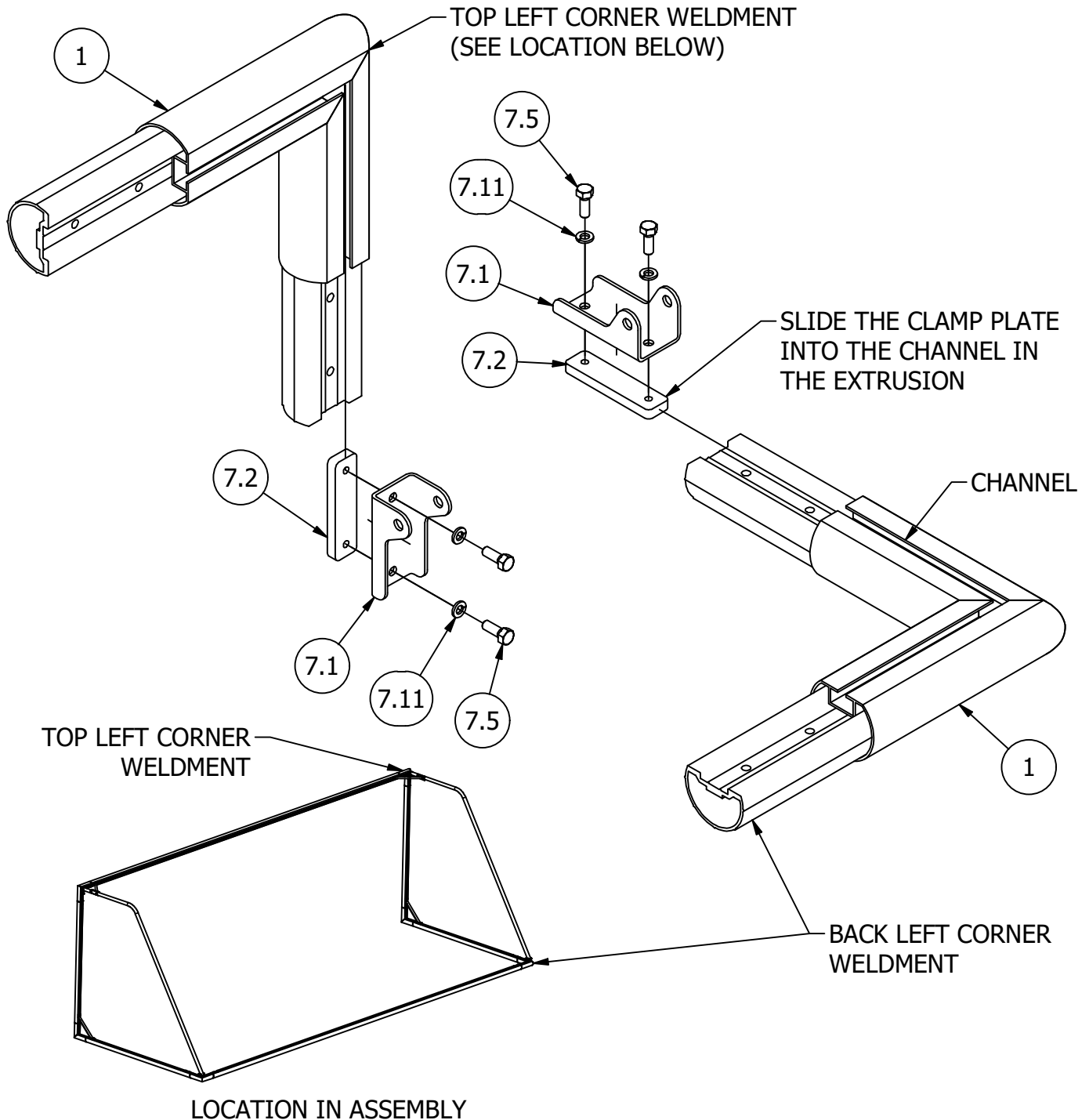

Step 2:

Place two Crossbar Corner Weldments (ITEM 1) and one Crossbar (ITEM 2) in a line on the ground. Select the two Crossbar Corner Weldments that match the illustration shown below. Connect each corner assembly to the Crossbar and secure the parts together with 3/8" x 1-1/2" Bolts (ITEM 7.6), 3/8" Flat Washers (ITEM 7.10), and 3/8" Lock Washers (ITEM 7.12). Do not add the outermost bolt, washer, and lock washer at this time. Tighten all bolts with the socket wrench and 9/16" socket.

BEFORE TIGHTENING, PULL FRAME PARTS TOGETHER SO THERE IS NO GAP BETWEEN FRAME PIECES.

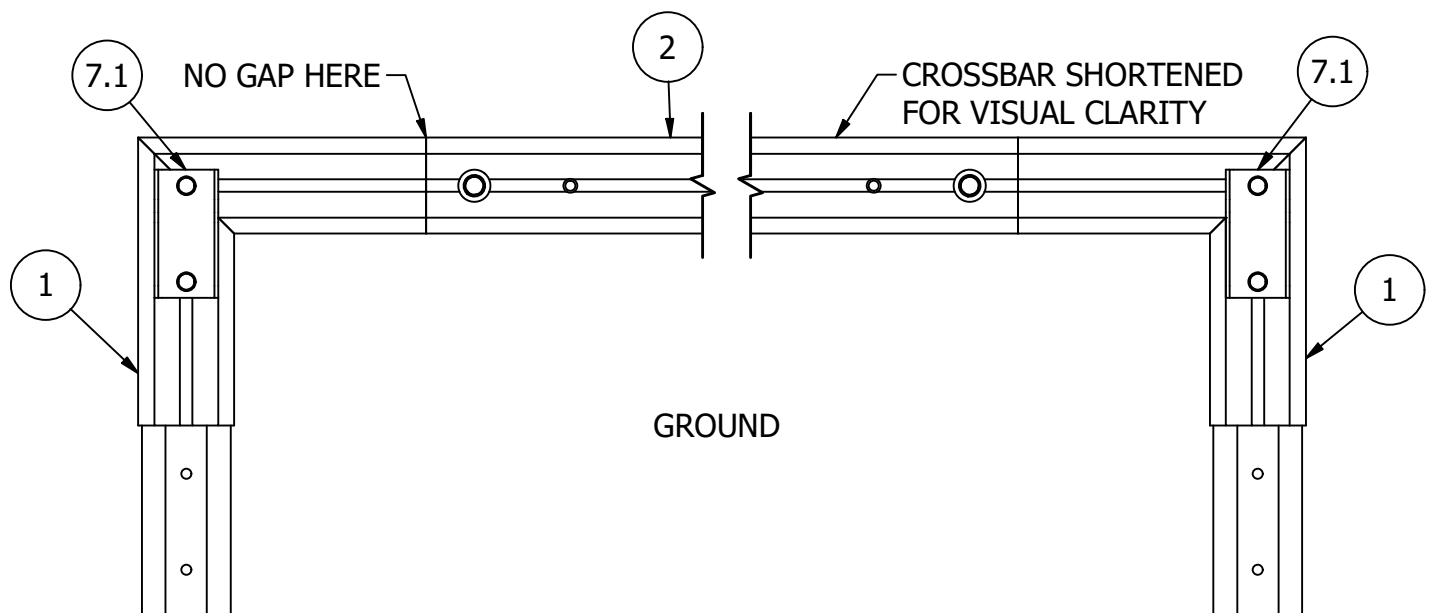
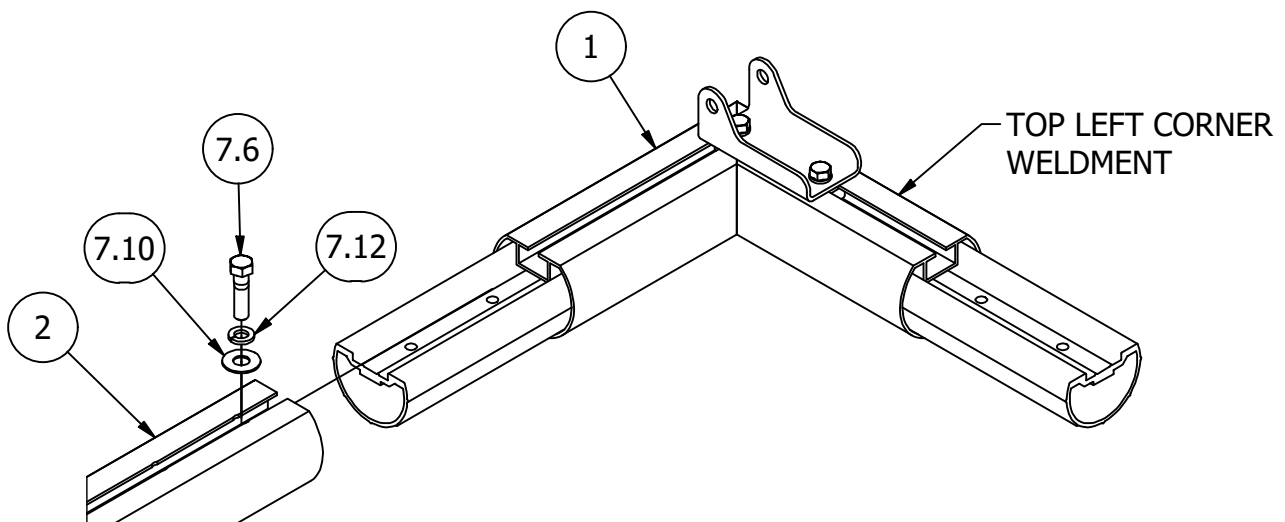

VIEW FROM ABOVE

Step 3:

Next, attach the two Side Rails (ITEM 4). These will be the shortest of the straight frame tubes. The length will match the table shown below. Slide each Side Rail onto the Crossbar Corner Weldment (ITEM 1). Secure the parts together with 3/8" x 1-1/2" Bolts (ITEM 7.6), 3/8" Flat Washers (ITEM 7.10), and 3/8" Lock Washers (ITEM 7.12). Tighten all bolts with the socket wrench and 9/16" socket.

BEFORE TIGHTENING, PULL FRAME PARTS TOGETHER SO THERE IS NO GAP BETWEEN FRAME PIECES.

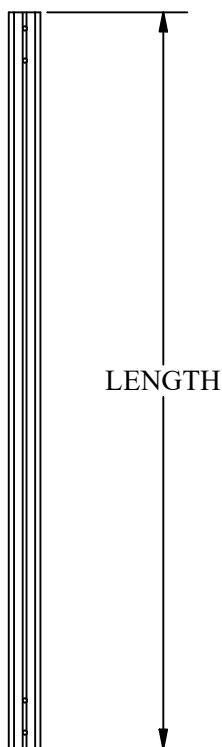
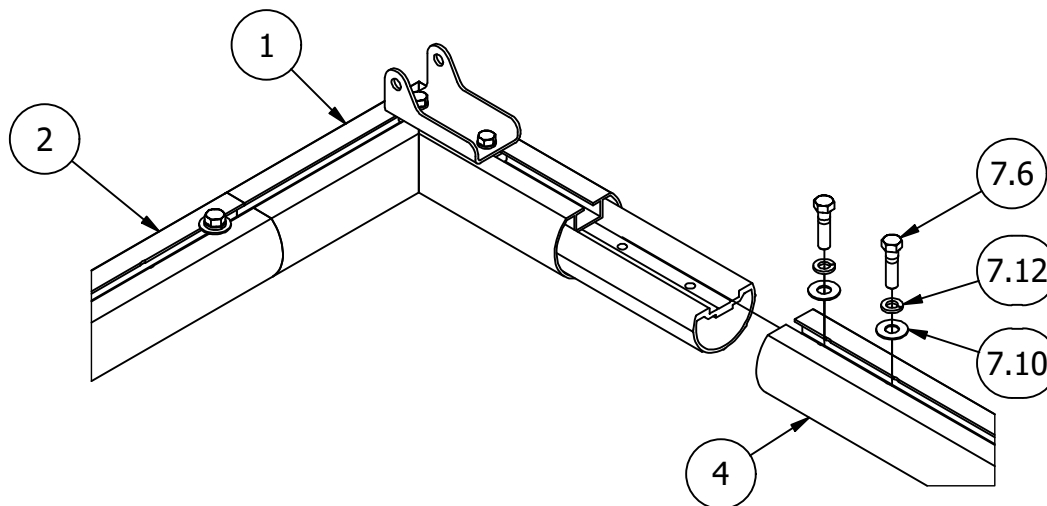

SIDE RAIL	
SYSTEM	LENGTH
SG3RD612SPT	5' - 3"
SG3RD618SPT	5' - 3"
SG3RD721SPT	5' - 9"
SG3RD824SPT	6' - 9"

Step 4:

Then, attach the Side Rail Corner Weldments (ITEM 3) to the assembly. These can be identified by the location of the channel as shown in the illustration below. Connect each Side Rail Corner Weldment to the Side Rails (ITEM 4) and secure the parts together with 3/8" x 1-1/2" Bolts (ITEM 7.6), 3/8" Flat Washers (ITEM 7.10), and 3/8" Lock Washers (ITEM 7.12). Do not add the outermost bolt, washer, and lock washer at this time. Tighten all bolts with the socket wrench and 9/16" socket.

BEFORE TIGHTENING, PULL FRAME PARTS TOGETHER SO THERE IS NO GAP BETWEEN FRAME PIECES.

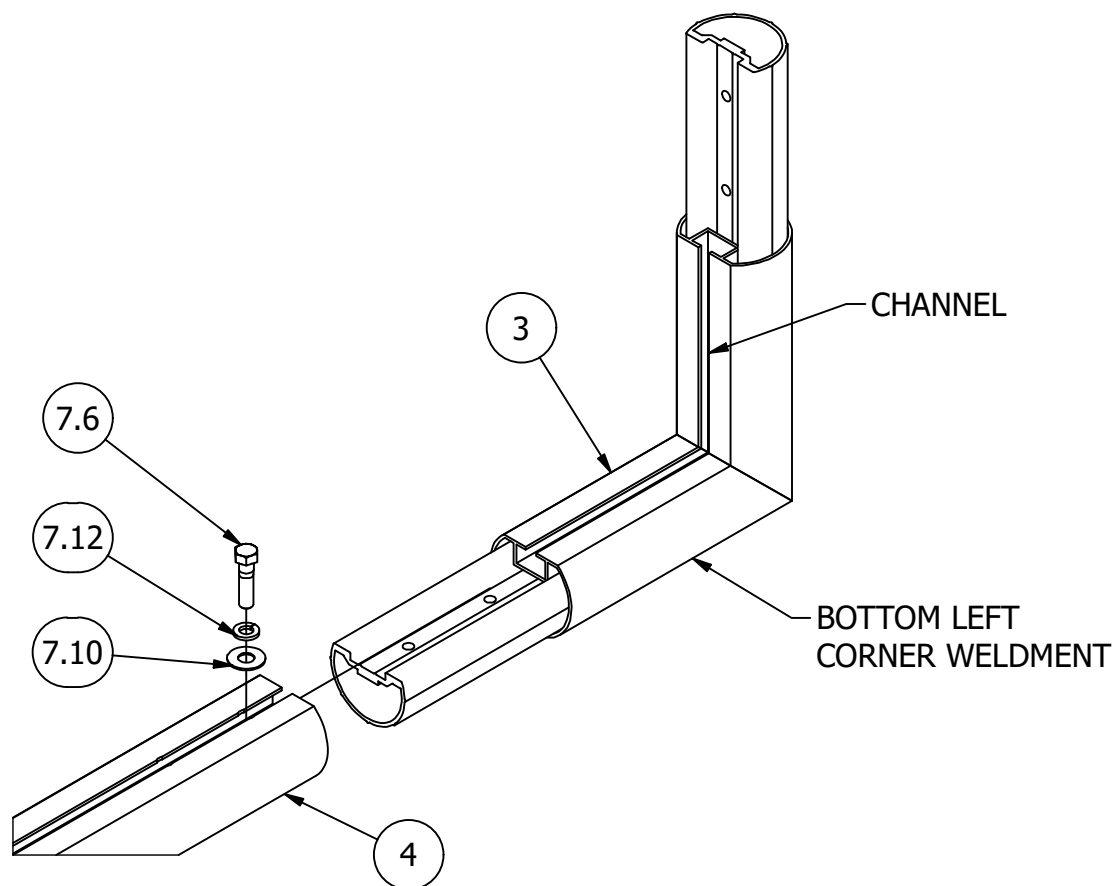

ASSEMBLY
FRONT VIEW



ASSEMBLY
SIDE VIEW

Step 5:

Next, attach the two Bottom Side Rails (ITEM 5). These will be longer than the Side Rails (ITEM 4). The length will match the table shown below. Slide each Bottom Side Rail onto the Side Rail Corner Weldment (ITEM 3). Secure the parts together with 3/8" x 1-1/2" Bolts (ITEM 7.6), 3/8" Flat Washers (ITEM 7.10), and 3/8" Lock Washers (ITEM 7.12). Do not add the outermost bolt, washer, and lock washer at this time. Tighten all bolts with the socket wrench and 9/16" socket.

BEFORE TIGHTENING, PULL FRAME PARTS TOGETHER SO THERE IS NO GAP BETWEEN FRAME PIECES.

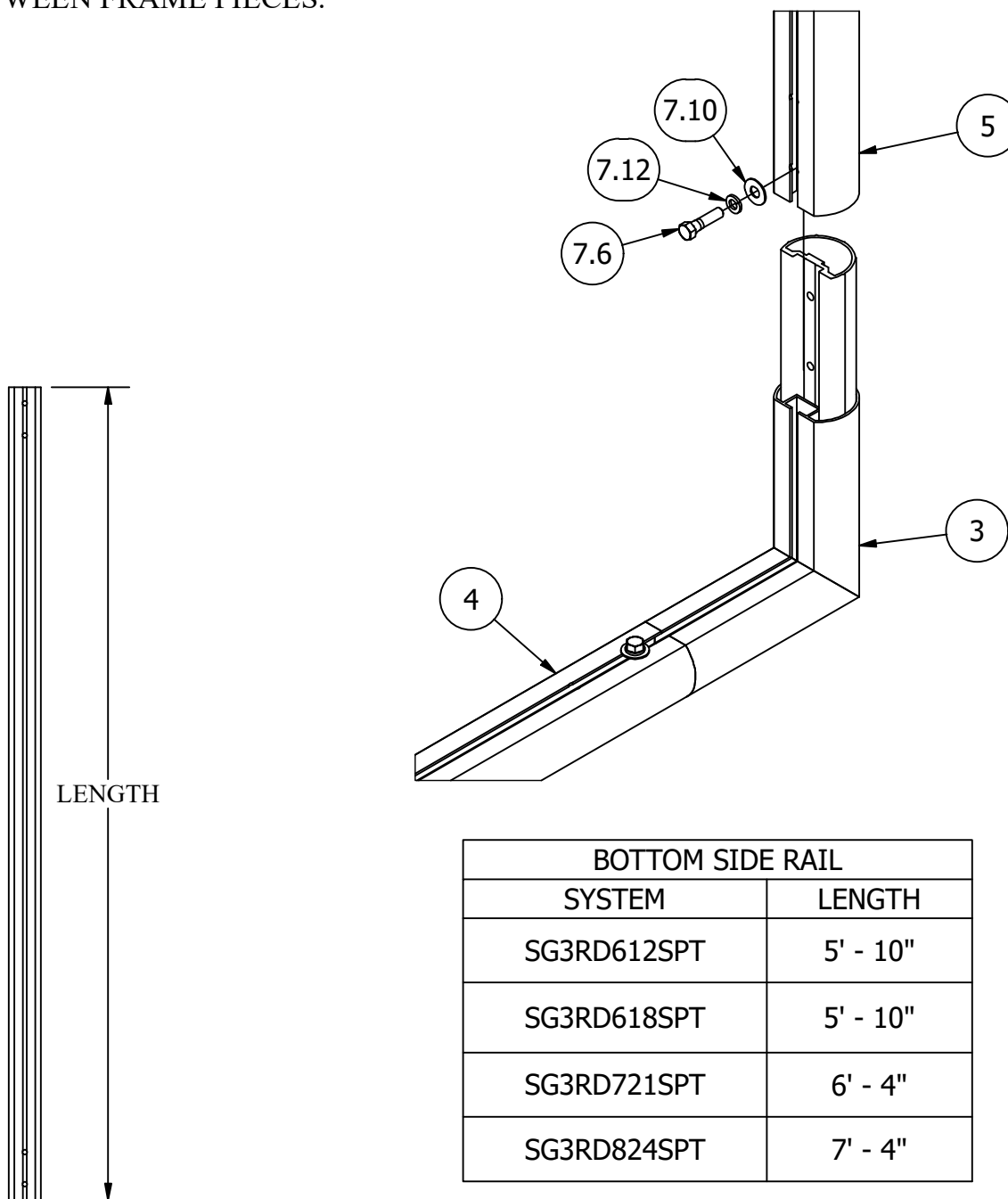

Step 6:

Then, add the Striker Frame Brace (ITEM 7.3) to each side rail corner assembly as shown in the illustration below. Use the 3/8" x 1-1/2" Bolts (ITEM 7.6), 3/8" Flat Washers (ITEM 7.10), and 3/8" Lock Washers (ITEM 7.12) to lock these parts together. Tighten all bolts with the socket wrench and 9/16" socket.

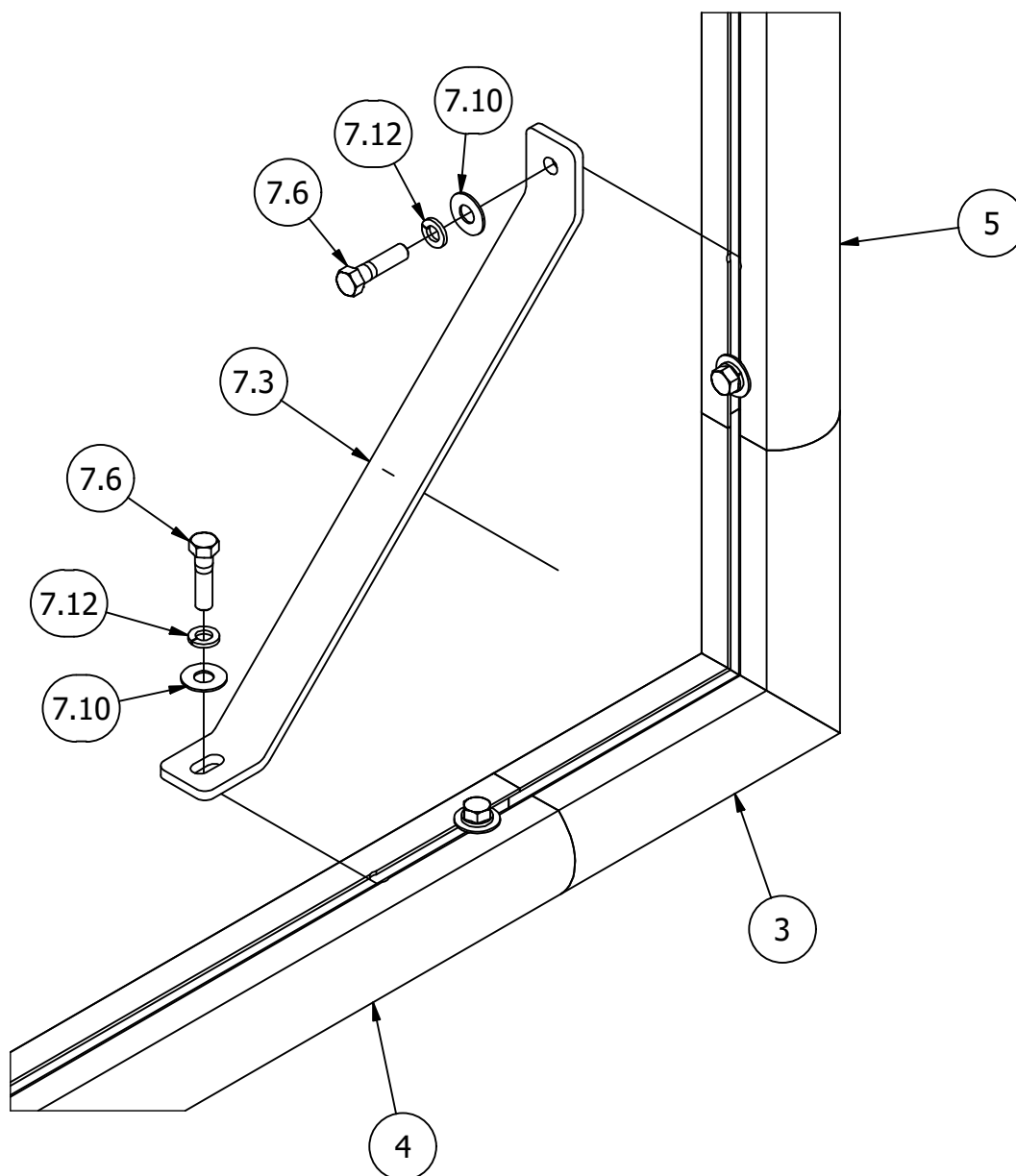

Step 7:

Attach the other two Crossbar Corner Weldments (ITEM 1) to the assembly. Use of a ladder may be required for this step. Connect each Crossbar Corner Weldment to the Bottom Side Rails (ITEM 5) and secure the parts together with 3/8" x 1-1/2" Bolts (ITEM 7.6), 3/8" Flat Washers (ITEM 7.10), and 3/8" Lock Washers (ITEM 7.12). Tighten all bolts with the socket wrench and 9/16" socket.

BEFORE TIGHTENING, PULL FRAME PARTS TOGETHER SO THERE IS NO GAP BETWEEN FRAME PIECES.

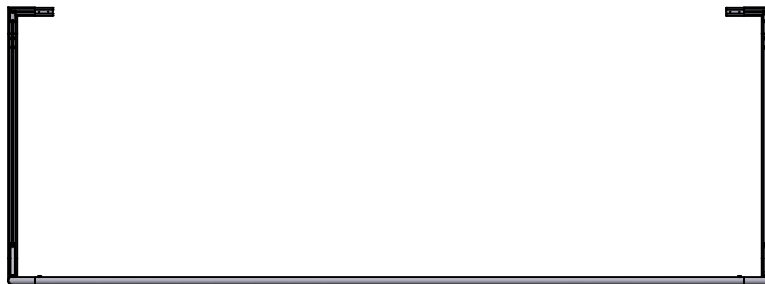
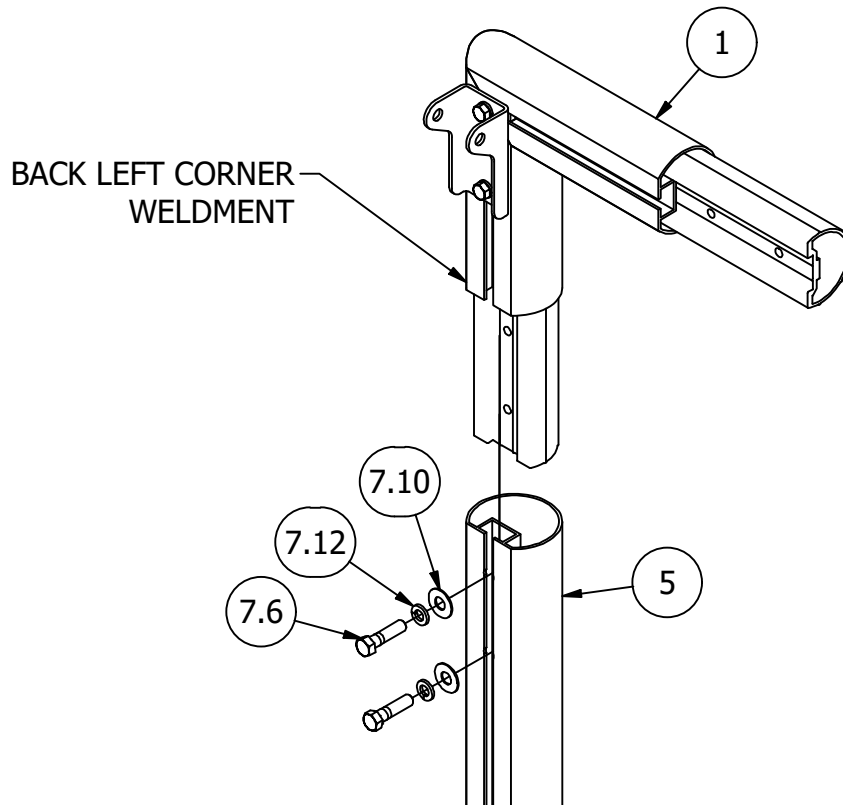

ASSEMBLY
FRONT VIEW

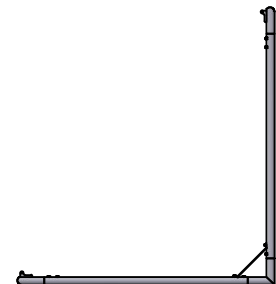

ASSEMBLY
SIDE VIEW

Step 8:

REQUIRES 2 OR MORE PEOPLE. Carefully rotate goal down as shown in the illustration below.

WARNING: PERFORM STEP 8 GRADUALLY AND CAREFULLY TO AVOID ANY UNCONTROLLED MOVEMENT OF THE GOAL.

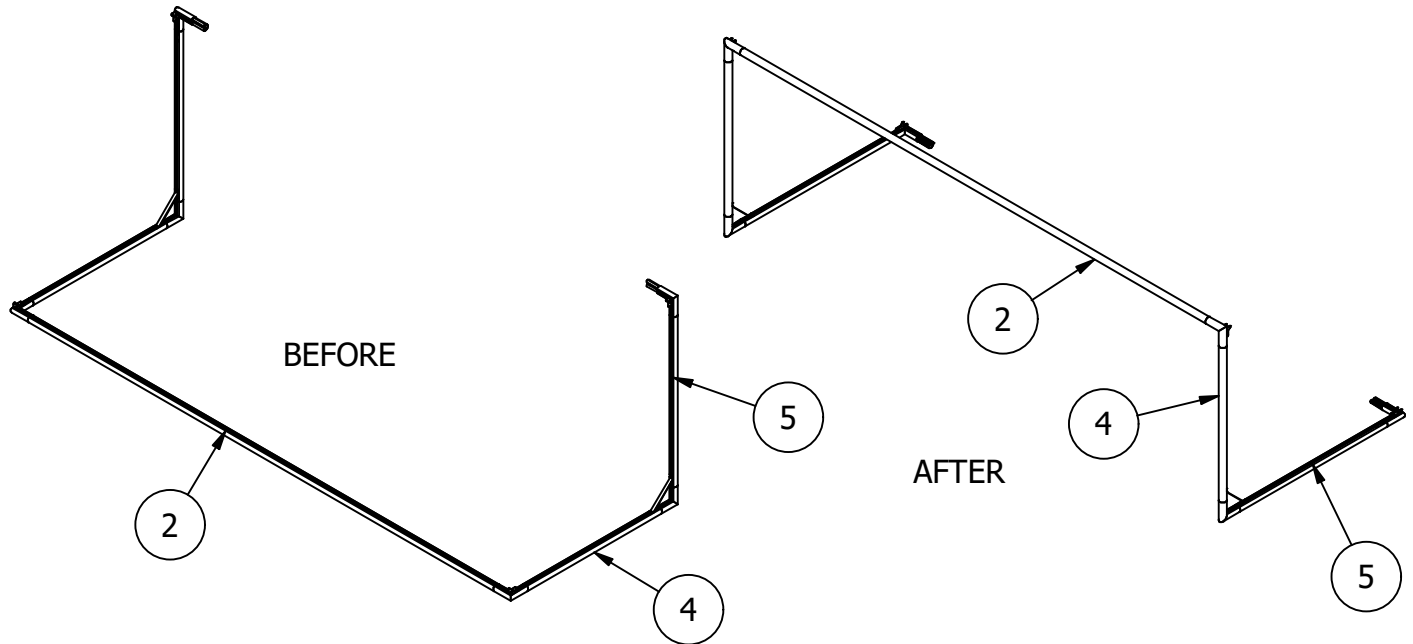

Step 9:

Attach the other Crossbar (ITEM 2) to the frame assembly. Connect the Crossbar to each corner assembly and secure the parts together with 3/8" x 1-1/2" Bolts (ITEM 7.6), 3/8" Flat Washers (ITEM 7.10), and 3/8" Lock Washers (ITEM 7.12). Tighten all bolts with the socket wrench and 9/16" socket.

BEFORE TIGHTENING, PULL FRAME PARTS TOGETHER SO THERE IS NO GAP BETWEEN FRAME PIECES.

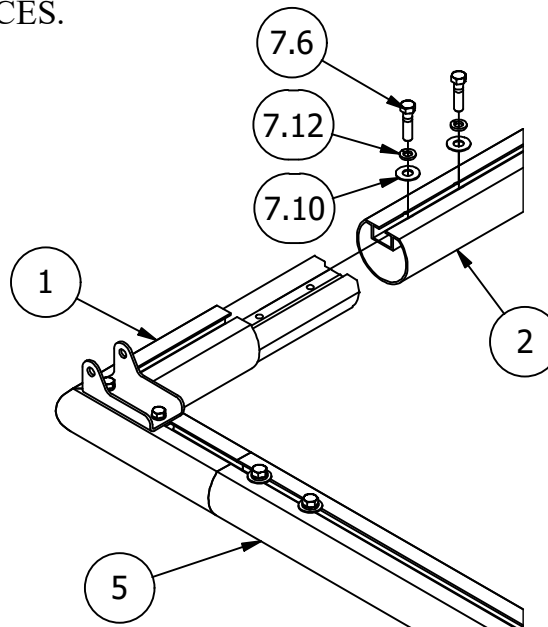

Step 10:

Assemble the Striker Backstays (ITEM 6) to each end of the goal. Connect the Striker Backstay to the Backstay Attachment Brackets (ITEM 7.1) using the 3/8" x 2-3/4" Bolts (ITEM 7.8), 3/8" Flat Washers (ITEM 7.10), and 3/8" Nylon Lock Nut (ITEM 7.9). Make sure the short section of the backstay is at the top of the goal as shown below. Shift the Backstay Attachment Brackets along the channel until the holes line up with the ones in the backstay.

First, lock the Backstay Attachment Brackets in place by tightening the 5/16" x 7/8" Bolts (ITEM 7.5) using a 1/2" wrench. Then, tighten the backstay bolts with two socket wrenches and 9/16" sockets. Finally, cover the Nylon Lock Nuts with a Plastic Bolt Cap (ITEM 7.13).

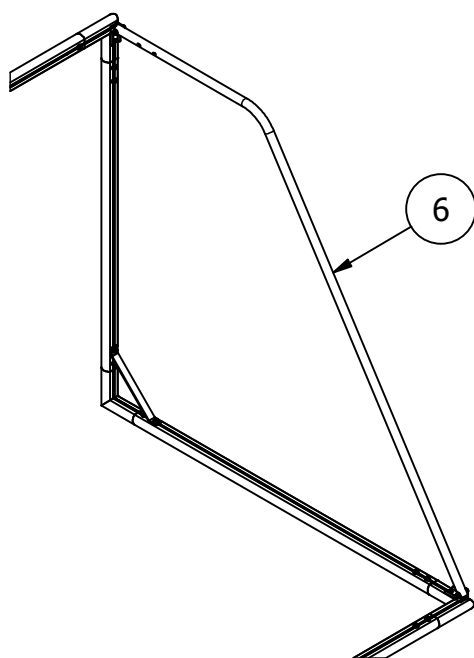
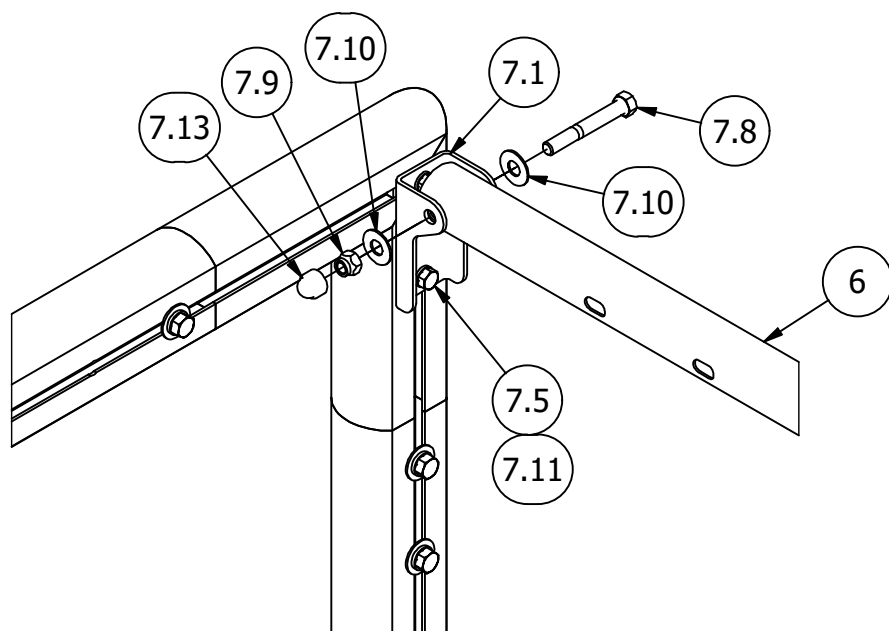

ASSEMBLED VIEW

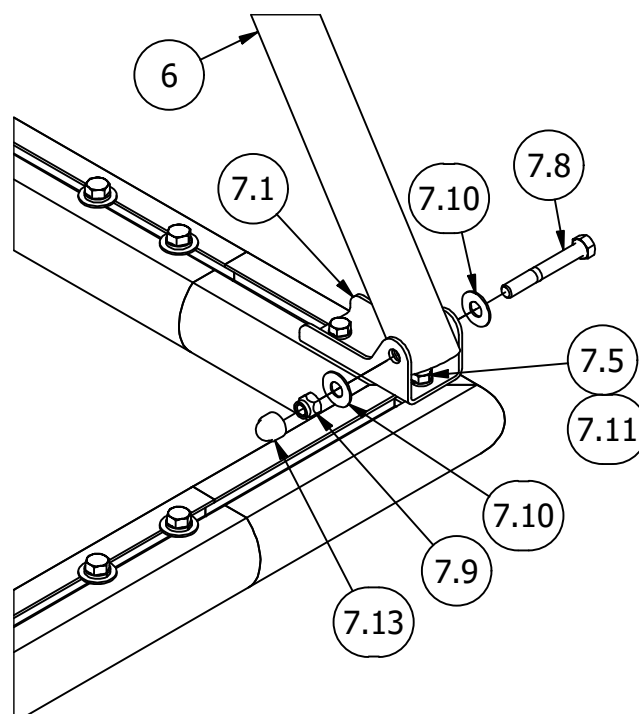

Step 11:

Next, attach the Striker Brace Weldments (ITEM 7.4) to the top corners of the goal. First, connect the small end of the Striker Brace Weldment to the Crossbar (ITEM 2) using a 3/8" x 1-1/2" Bolt (ITEM 7.6), 3/8" Flat Washer (ITEM 7.10), and 3/8" Lock Washer (ITEM 7.12). Next, attach the other end to the Striker Backstay (ITEM 6) using 3/8" x 2-1/2" Bolts (ITEM 7.7), 3/8" Flat Washers (ITEM 7.10), and 3/8" Nylon Lock Nuts (ITEM 7.9).

First, tighten the single bolt on the small end of the Striker Brace Weldment using a socket wrench and 9/16" socket. Then, tighten the backstay bolts with a socket wrench, 9/16" socket, and 9/16" wrench. Finally, cover the Nylon Lock Nuts with a Plastic Bolt Cap (ITEM 7.13).

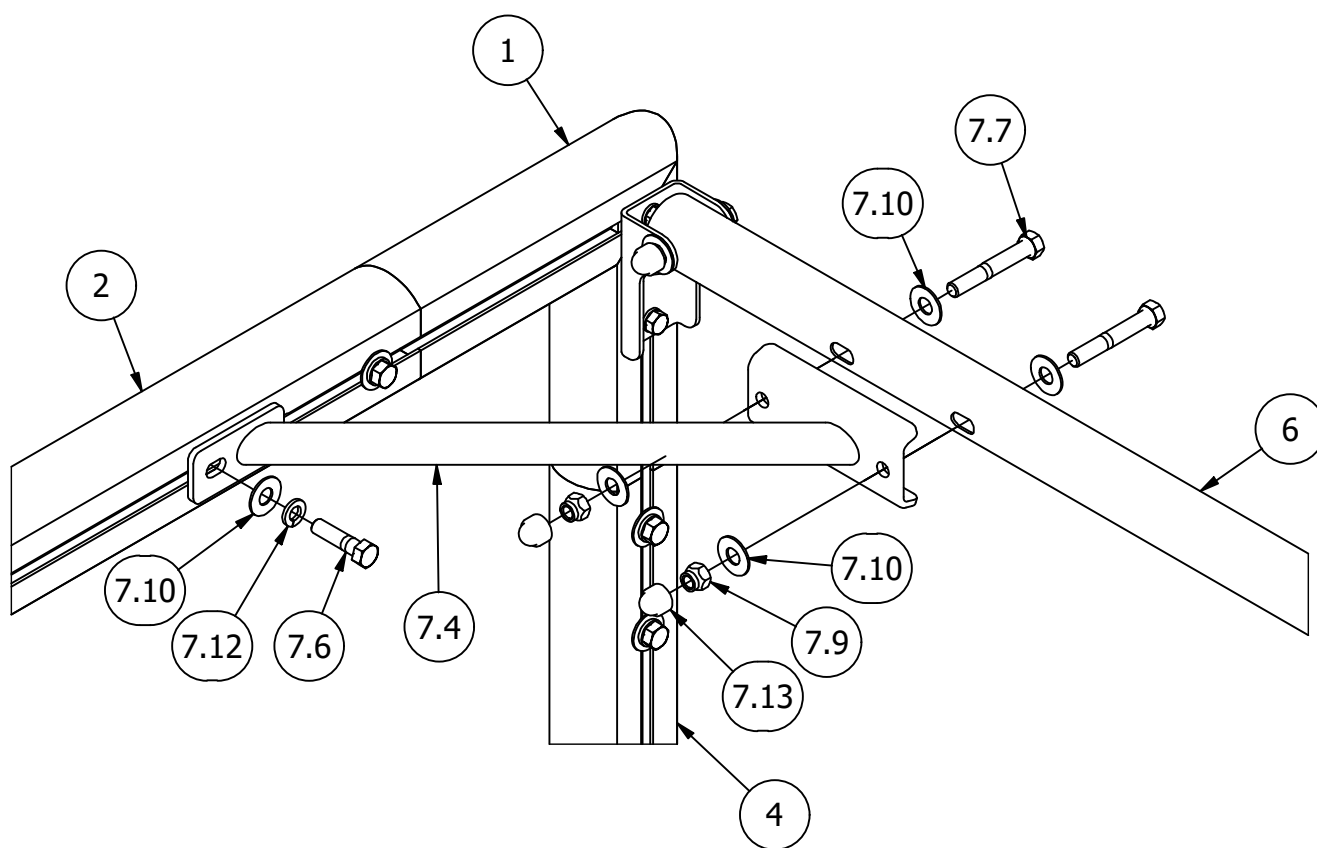

Step 12:

Check all connections and make sure the goal is stable. When the goal is properly positioned on the playing field, place two Soccer Weight Bags (ITEM 7.20) filled with sand on the rear frame of the goal as shown below. Use the weight bag straps to secure the weight bags to the soccer goal frame.

Soccer Weight Bags are shipped standard with the goal. Sand is not included and will need to be sourced elsewhere.

Underground anchors are available as a separate item and at additional cost.

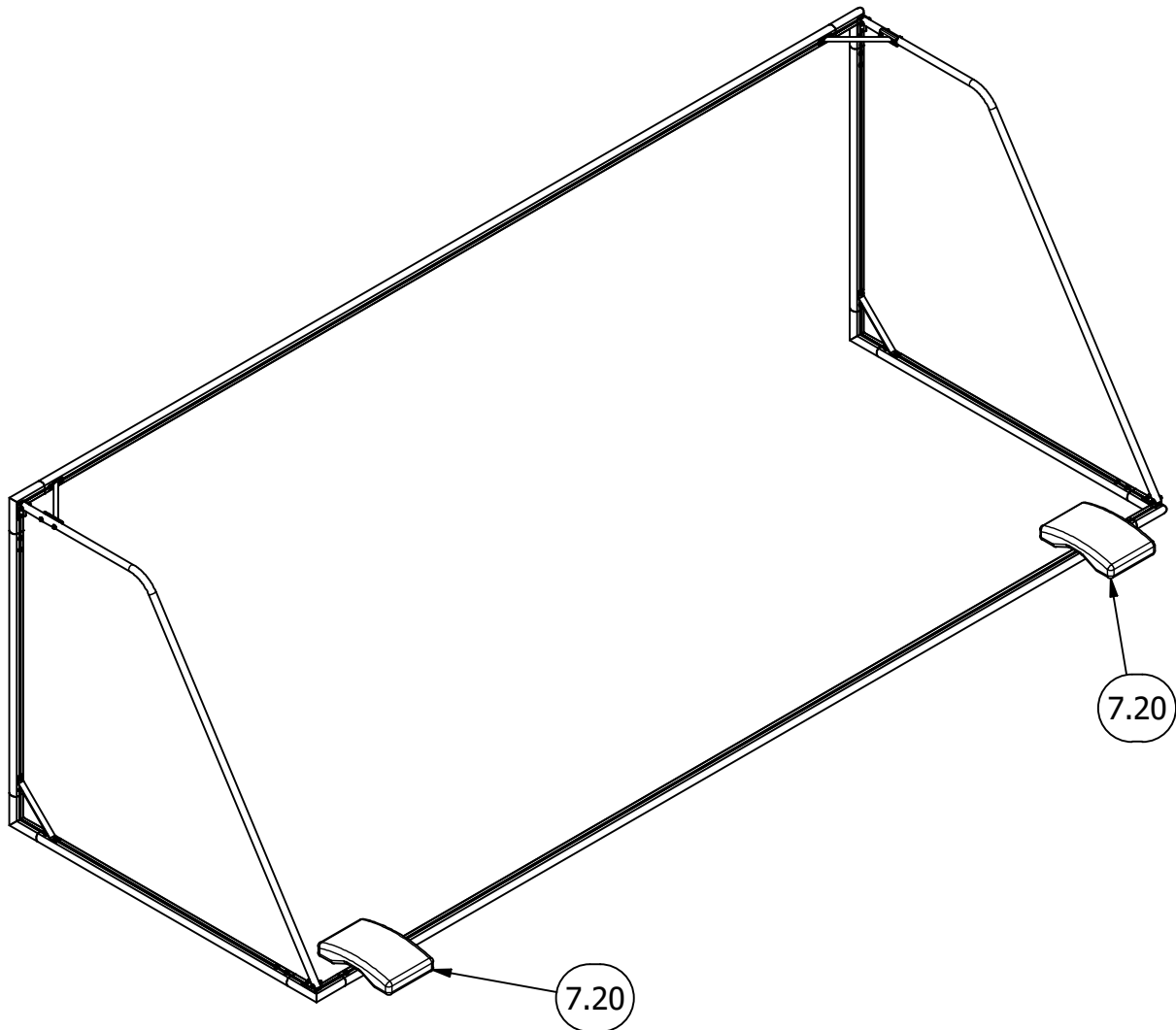

⚠ WARNING

Portable or Moveable Soccer Goals can fall over causing serious injury or death. Anchors must be properly installed and used on all portable or moveable soccer goals at ALL times.

Step 13:

Attach the Soccer Net (ITEM 8) to the goal. Drape net over Striker Backstays (ITEM 6) and attach to the frame using the Net Clips (ITEM 7.14). Insert the clips over the edge of the net as shown. Rotate the clip 90° and insert it into the channel. When fully inserted, rotate it back 90° to lock it into the channel. (See the illustration below)

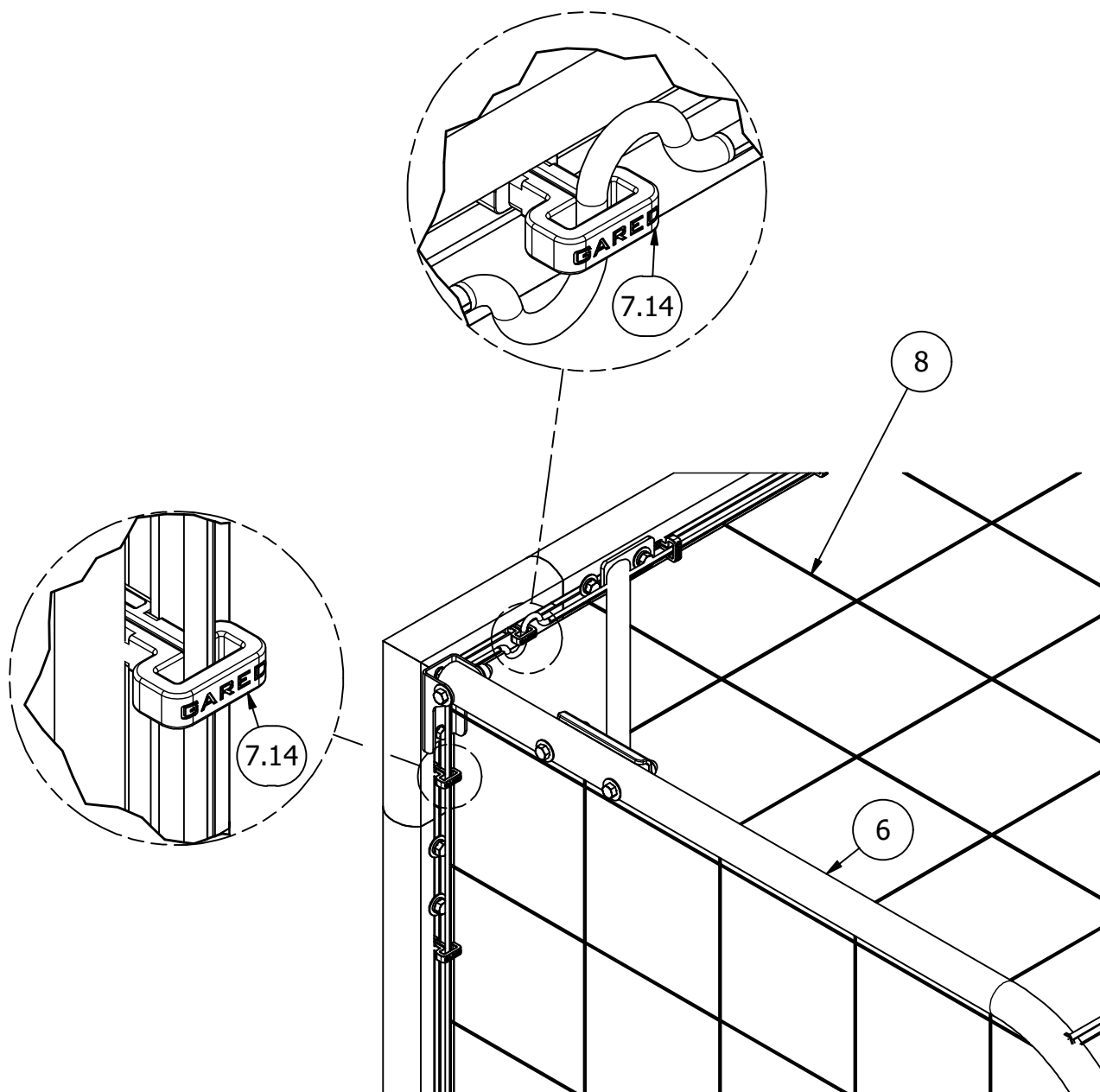

Step 14:

Attach the warning labels and decals on the Soccer Goal.

Place the General Soccer Warning Label (ITEM 7.16) in the center of the crossbar where it is readable from the ground.

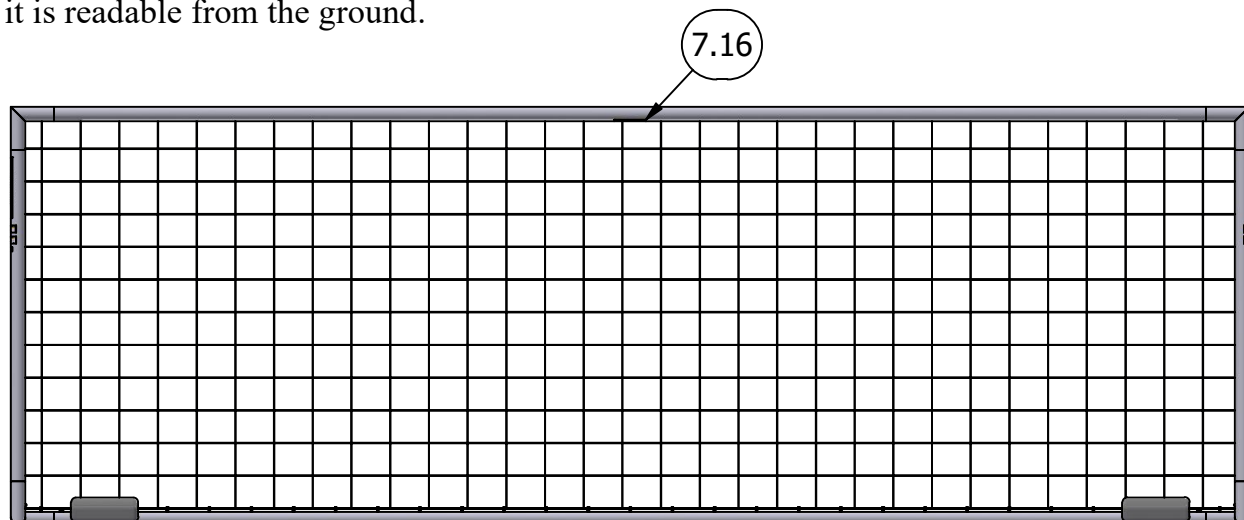

Place the GPSS Soccer Decal (ITEM 7.15), Never Climb Warning Label (ITEM 7.17), Always Anchor Warning Label (ITEM 7.18), and ASTM F2950-14 Label (ITEM 7.19) at eye level on each of the Side Rails (ITEM 4).

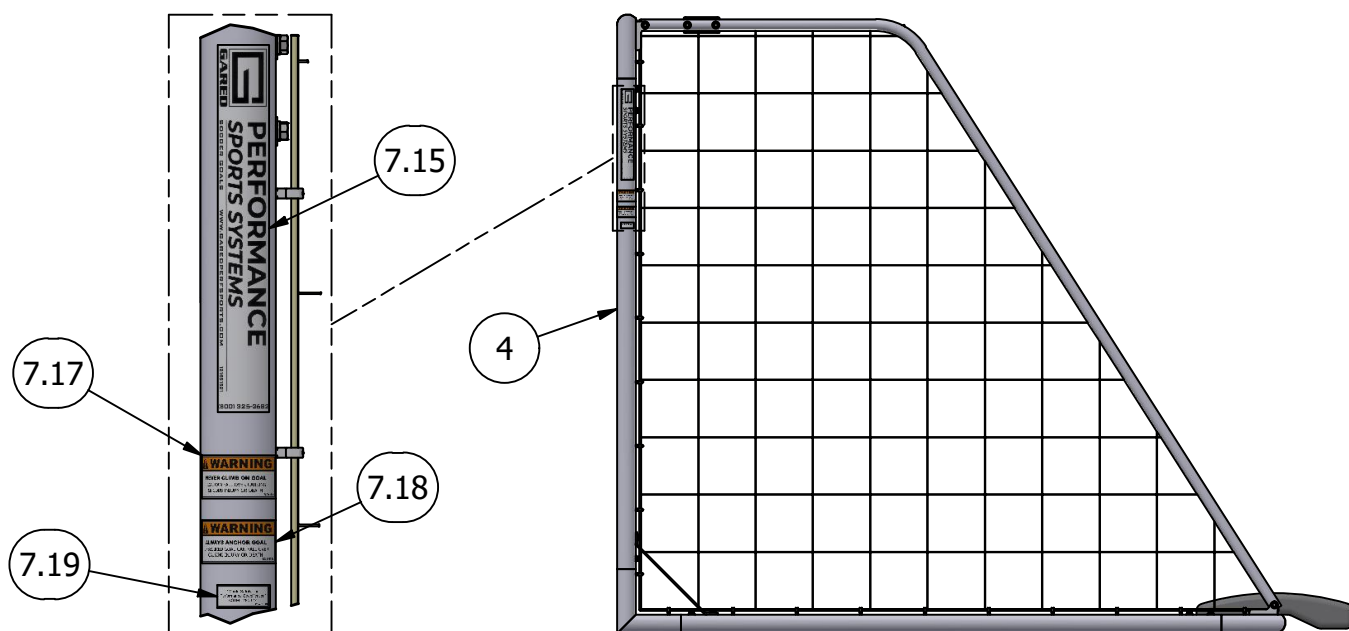

Storage Guidelines

Whenever possible, remove the nets and place two goals face to face as shown below. Join the goal faces and lock together using chain and lock.

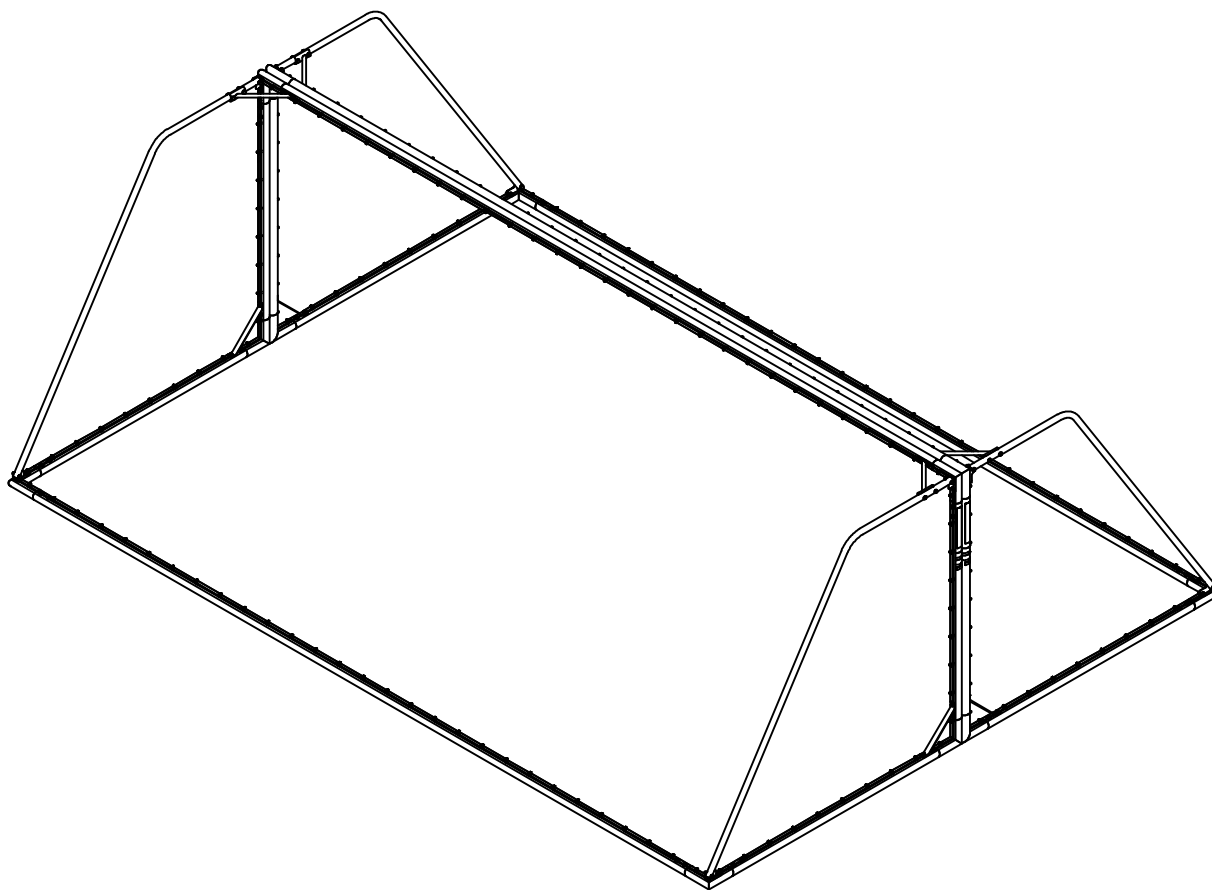

When goals cannot be stored together as shown above, remove the nets and chain the goal frame to a fence post, dugout, or any other sturdy structure. When this is not possible, store movable soccer goals in an area that is not available to children.

Maintenance

- 1) General inspection of equipment should be performed before use to ensure no catastrophic failures have occurred during the course of use between yearly inspections.
- 2) It is recommended that yearly inspections be conducted to determine if any bolts or other hardware has become worn or loosened.
- 3) During yearly inspections, check all joints to make sure they are tight and secure. Check the net for wear, holes, torn rope, etc.
- 4) Any loose bolts or nuts should be tightened.
- 5) Replace any components that are missing or worn.