

PARTS LIST

Reference	Qty	Description	Qty	Description
A	(2)	61-1/4" Tube	(1)	Vinyl Skirt
B	(6)	61-1/4" Tube with swag	(6)	Release Ty-raps
C	(2)	20-1/2" Tube	(1)	Webbing Strap
1	(2)	10-8 Kee Klamp	(20)	Bungee Cords
2	(2)	15-8 Kee Klamp	(10)	Adjustable Straps
	(2)	2" i.d. PVC sleeves	(1)	Set Screw Key
	(1)	Rebound Net		

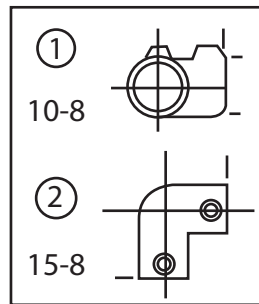

1. Sink PVC sleeves to a depth of 2' in concrete at least 3' deep, as shown in the illustration.
2. Assemble the bottom bar over the holes as a guide. Lift off, lay down, and finish assembly of the frame on the ground. Use a set screw key to secure poles in fittings. Be sure the whole frame is assembled before installing the netting.
3. To install netting, hook and fasten bungee cords evenly along the sides and top of the frame. Evenly space and tighten down the (10) adjustable straps along the bottom of the netting.
4. Attach the vinyl skirt at the bottom using ty-raps. Thread white webbing into the netting at the desired height to simulate the net height.

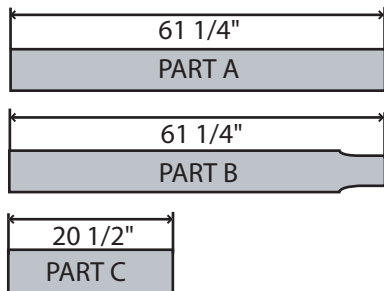